

# GRUPPO RENOLD CATENE RENOLD SOVEREIGN SEMPLICI ISO

## RENOLD GROUP RENOLD CHAIN SOVEREIGN SIMPLEX ISO

# RENOLD Sovereign

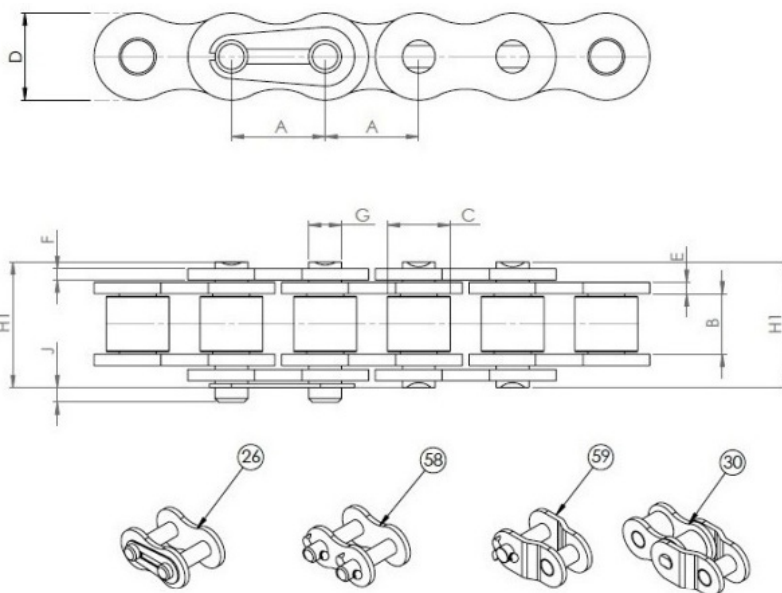

### ISO STANDARD

CHAIN CODE	REF.	A - PITCH (MM)	B - INSIDE WIDTH	C - ROLLER DIAM MIN	D - PLATE HEIGHT MAX	E - PLATE WIDTH INNER MAX	F - PLATE WIDTH OUTER MAX	G - PIN DIAM. MAX	H1 - PIN LENGTH MAX	ISO606 TENSILE STRENGTH (NEWTONS) MIN	WEIGHT KG/M
6908B1SOV	08B1SOV	12.700	7.750	8.510	11.700	1.550	1.550	4.450	16.500	17800	0.700
6910B1SOV	10B1SOV	15.875	9.650	10.160	14.600	1.550	1.550	5.080	18.800	22200	0.960
6912B1SOV	12B1SOV	19.050	11.680	12.070	16.000	1.810	1.810	5.720	21.900	28900	1.220
6916B1SOV	16B1SOV	25.400	17.020	15.880	21.080	3.760	3.100	8.280	34.900	60000	2.800