

# GRUPPO RENOLD CATENE RENOLD SOVEREIGN DOPPIE ASA

RENOLD GROUP RENOLD CHAIN SOVEREIGN DUPLEX ASA

## RENOLD Sovereign

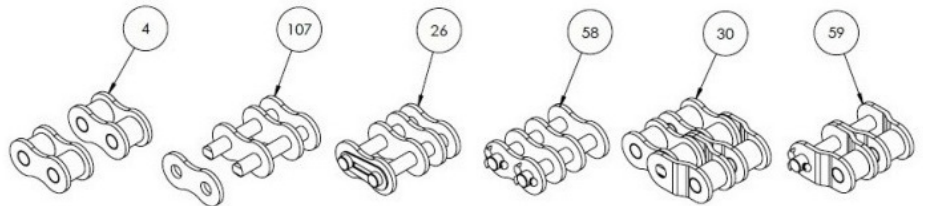
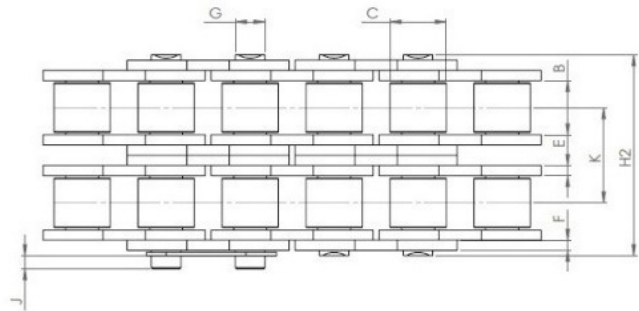
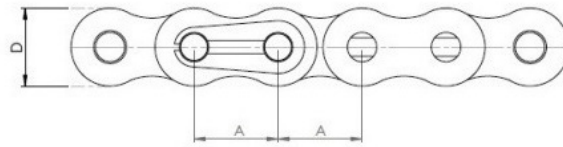

### ANSI STANDARD

CHAIN CODE	REF.	A - PITCH (MM)	B - INSIDE WIDTH	C - ROLLER DIAM MIN	D - PLATE HEIGHT MAX	E - PLATE WIDTH INNER MAX	F - PLATE WIDTH OUTER MAX	G - PIN DIAM. MAX	H1 - PIN LENGTH MAX	K - TRANVERSE PITCH NOM	ISO606 TENSILE STRENGTH (NEWTONS) MIN	WEIGHT KG/M
6940A2SOV	40A2SOV	12.700	7.850	7.920	11.200	1.550	1.550	3.970	30.800	14.38	27800	1.200
6950A2SOV	50A2SOV	15.875	9.400	10.160	14.600	2.040	2.040	5.080	38.400	18.11	43600	1.980
6960A2SOV	60A2SOV	19.050	12.570	11.910	17.500	2.450	2.450	5.940	48.100	22.78	62600	2.910
6980A2SOV	80A2SOV	25.400	15.750	15.880	24.130	3.250	3.250	7.940	61.900	29.29	111200	5.500