

# CATENE OE ZINCATE SEMPLICI ISO

## CHAIN ZINC PLATED SIMPLEX ISO

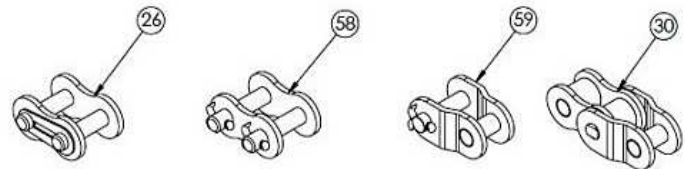

**RENOLD**  
Superior Chain Technology

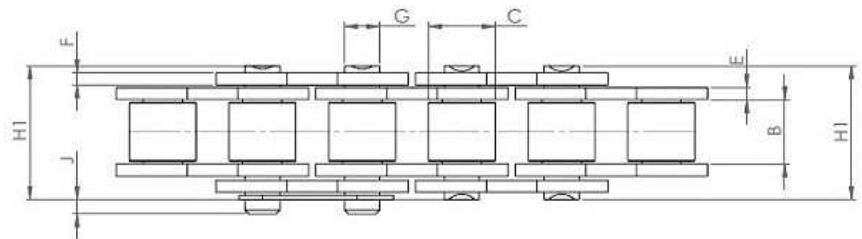
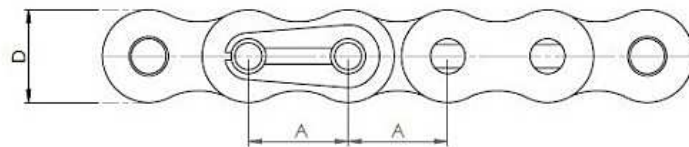

### ISO STANDARD

CHAIN CODE	REF.	A - PITCH (MM)	B - INSIDE WIDTH	C - ROLLER DIAM MIN	D - PLATE HEIGHT MAX	E - PLATE WIDTH INNER MAX	F - PLATE WIDTH OUTER MAX	G - PIN DIAM. MAX	H1 - PIN LENGTH MAX	J - CONN. LINK EXTENSION MAX	ISO606 TENSILE STRENGTH (NEWTONS) MIN	ISO606 TENSILE STRENGTH (NEWTONS) MED	WEIGHT KG/M
532191000	06B1	9.525	5.720	6.350	8.260	1.300	1.040	3.280	13.500	1.300	8900	8900	0.390
531603000	08B1	12.700	7.750	8.510	11.810	1.550	1.550	4.450	17.000	1.500	17800	17800	0.700
531623000	10B1	15.875	9.650	10.160	14.730	1.550	1.550	5.080	18.800	1.300	22200	22200	0.920
531642000	12B1	19.050	11.680	12.070	16.130	1.800	1.800	5.720	21.900	1.100	28900	28900	1.200
531666000	16B1	25.400	17.020	15.880	21.080	3.760	3.100	8.280	36.100	5.400	60000	60000	2.800
531682000	20B1	31.750	19.560	19.050	26.420	4.620	3.610	10.190	43.200	6.100	95000	95000	3.850
531702000	24B1	38.100	25.400	25.400	33.400	6.100	5.080	14.630	53.400	6.600	160000	160000	7.450